

### **ASSEMBLY INSTRUCTIONS:**

---

- **STAR SNARE DRUM CARRIER**
- **STAR BASS DRUM CARRIER**
- **STAR MULTI-CARRIER**
- **SHELL MOUNT ADAPTOR ASSEMBLY**
- **J-BAR SNARE CARRIER ASSEMBLY**

**ASSEMBLY INSTRUCTIONS FOR THE STAR SNARE DRUM CARRIER**

**LEGEND:**

1.  $\frac{5}{16}$ " x 1" carriage bolt, shoulder strap (A), cross bar (B), washer, nyloc nut\*.
2.  $\frac{1}{4}$ " x 1" carriage bolt, cross bar (B), chest support bar (C), washer, nyloc nut\*.
3.  $\frac{1}{4}$ " x 1" carriage bolt, waist pad support bar (D), chest support bar (C), washer, nyloc nut\*.
4.  $\frac{1}{4}$ " x 1  $\frac{1}{4}$ " carriage bolt, waist pad support bar (D), drum support (F), drum hanger (G), washer, nyloc nut\*.
5. Nyloc nut\*, washer, drum hanger (G), washer, lock nut, plastic bolt cover, anchor bolt.
6. Nyloc nut\*, washer, drum support (F), washer, lock nut, washer, bumper,  $\frac{1}{4}$ " x 3" bolt.

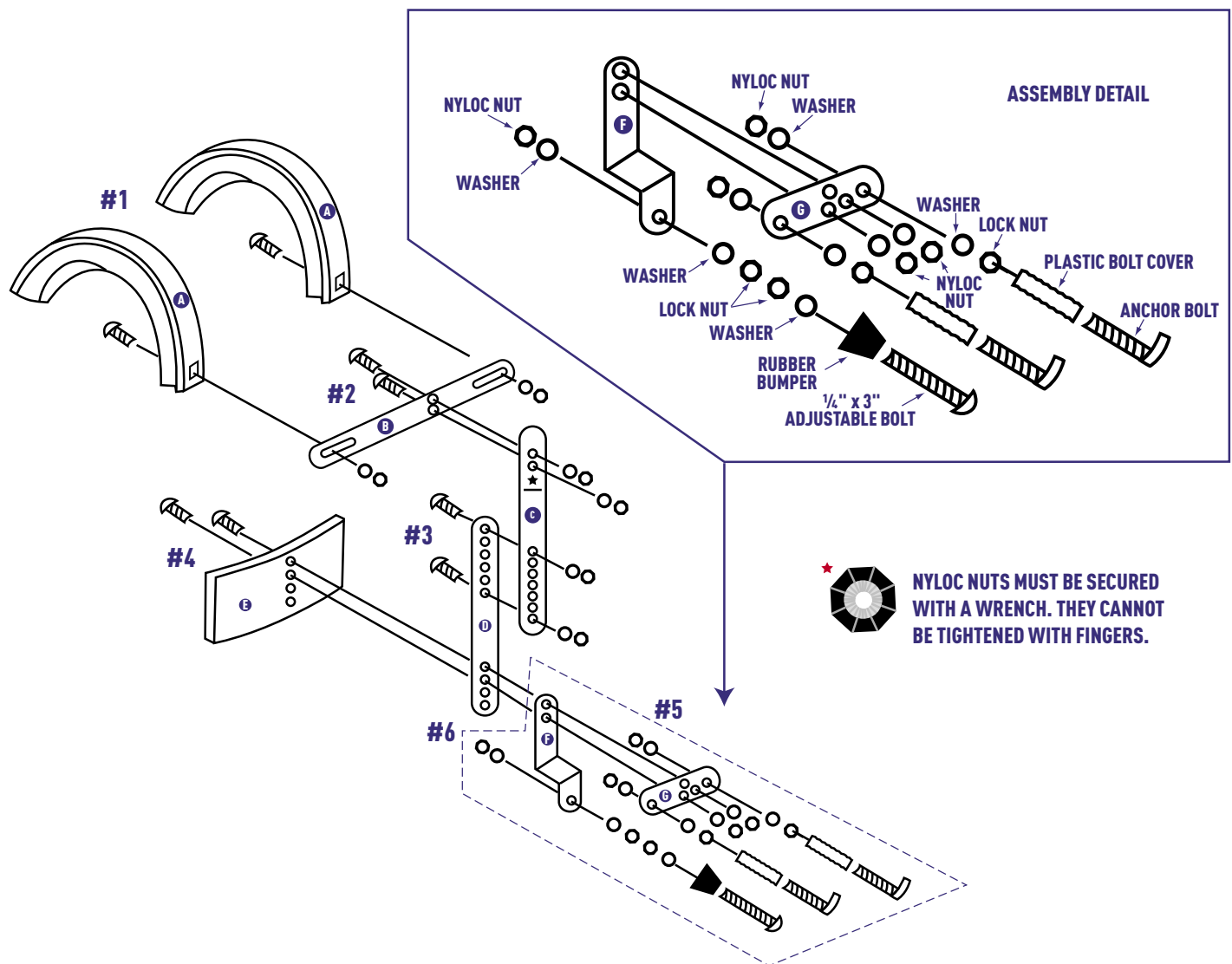

**SHELL MOUNT ADAPTOR ASSEMBLY**

1. Place screws through countersunk holes and through metal sleeves before passing through straight holes in other end.
2. Attach this assembly through star carrier drum support (Part F), waist pad support bar (Part D) and waist pad (Part E). Tighten down enclosed nuts snugly; your carrier will now work with a Yamaha or Pearl shell mount drum.

**SIDE VIEW**

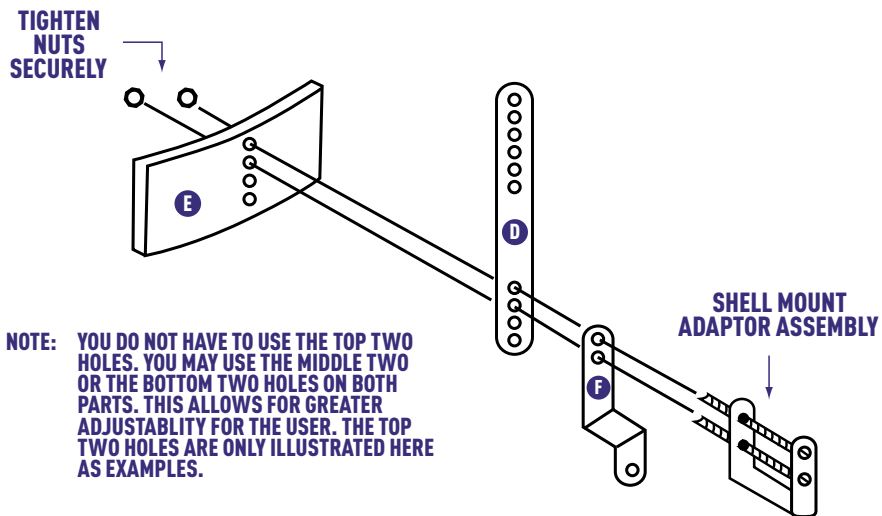
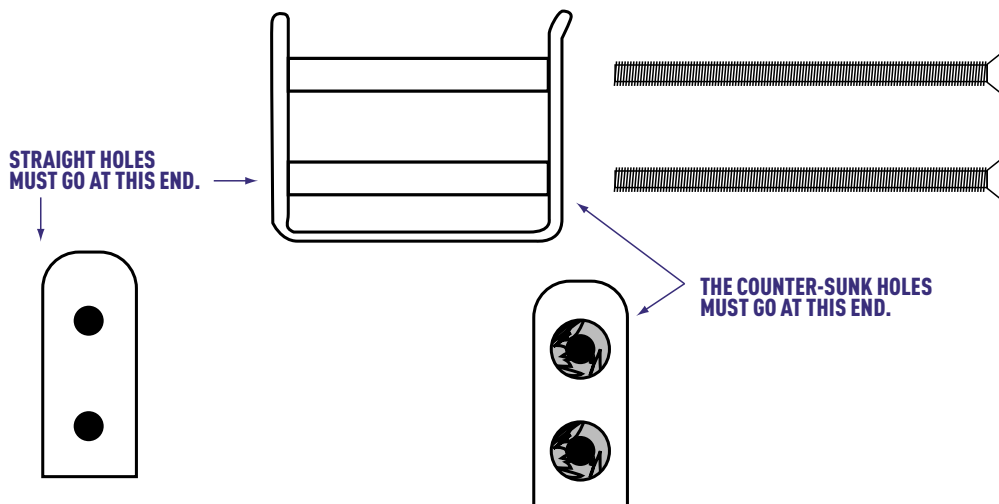

**ASSEMBLY INSTRUCTIONS FOR THE STAR BASS CARRIER**

**LEGEND:**

1. Nyloc nut\*, washer, shoulder strap (A), cross bar (B), washer, locknut, "J" hook.
2. 1/4" x 1" carriage bolt, cross bar (B), chest support bar (C), washer, nyloc nut\*.
3. 1/4" x 1" carriage bolt, waist pad support bar (D), chest support bar (C), washer, nyloc nut\*.
4. 1/4" x 1 1/4" carriage bolt, waist pad (E), waist pad support bar (D), drum support (F), washer, nyloc nut\*.

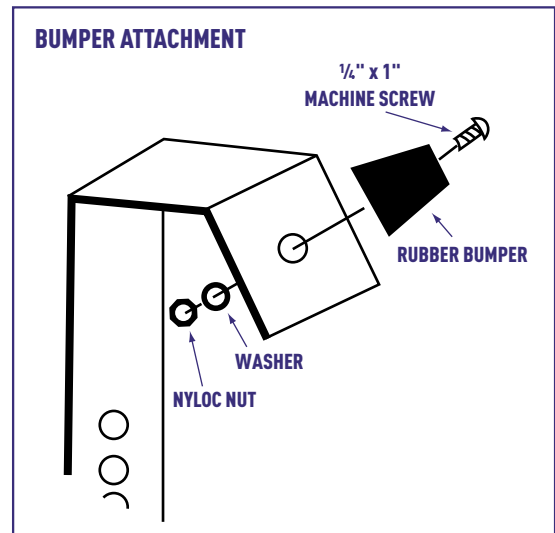
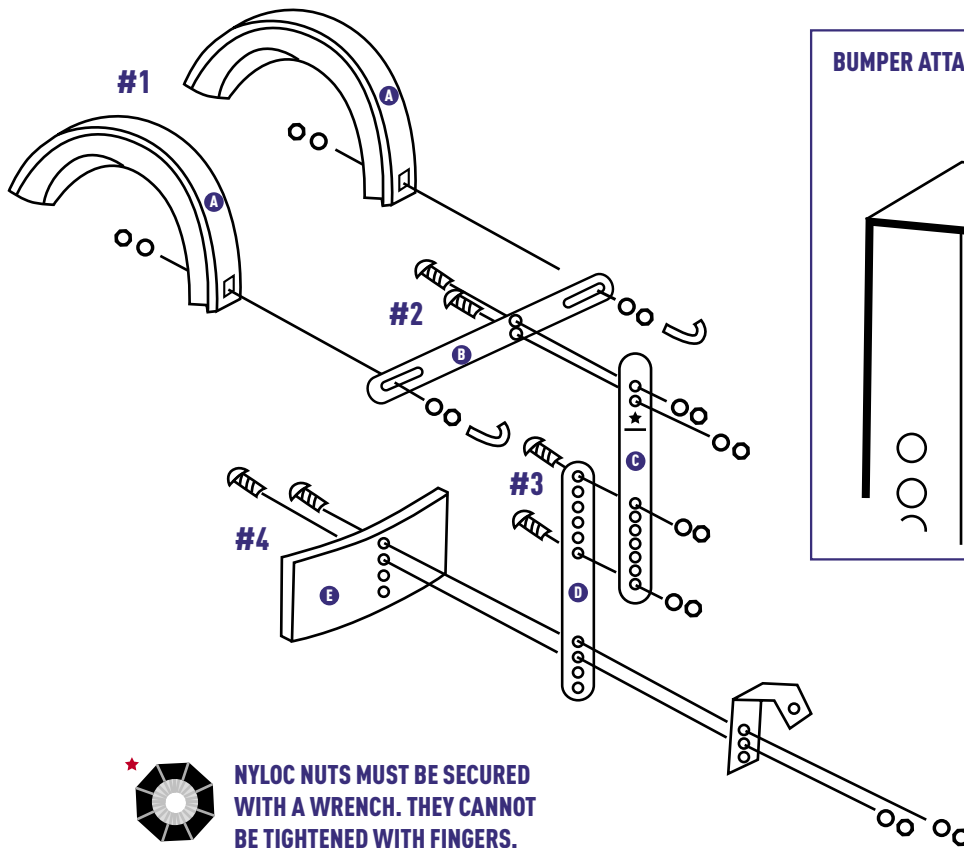

**★ NYLOC NUTS MUST BE SECURED WITH A WRENCH. THEY CANNOT BE TIGHTENED WITH FINGERS.**

**ASSEMBLY INSTRUCTIONS FOR THE STAR MULTI-CARRIER**

**LEGEND:**

1.  $\frac{5}{16}$ " x 1" carriage bolt, shoulder strap (A), cross bar (B), washer, nyloc nut\*.
2.  $\frac{1}{4}$ " x 1" carriage bolt, cross bar (B), chest support bar (C), washer, nyloc nut\*.
3.  $\frac{1}{4}$ " x 1" carriage bolt, waist pad support bar (D), chest support bar (C), washer, nyloc nut\*.
4. Keyhole screws (top and bottom holes of waist pad), washer, nyloc nut\*.  
 $\frac{1}{4}$ " x 1" carriage bolts go through two center holes in waist pad and attach to multi-carrier assembly.

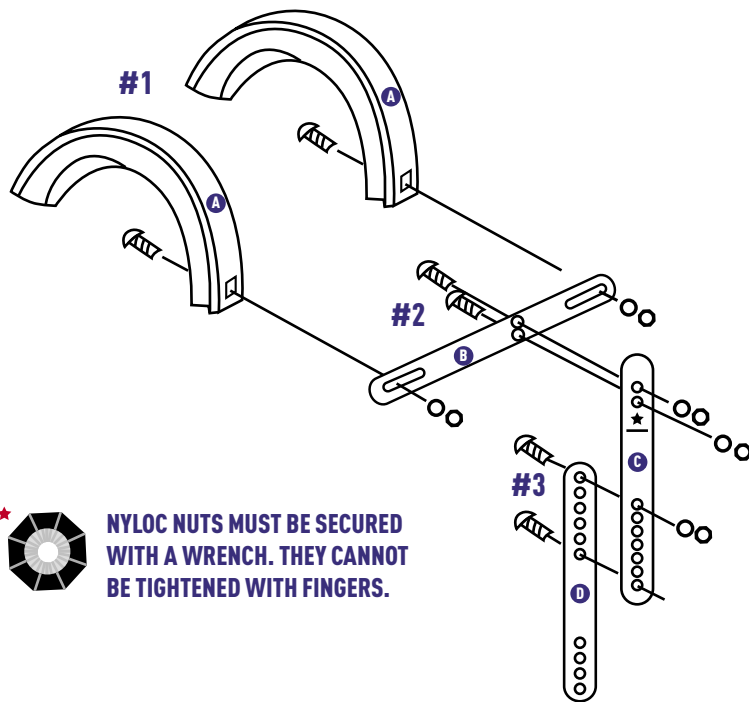

**★ NYLOC NUTS MUST BE SECURED WITH A WRENCH. THEY CANNOT BE TIGHTENED WITH FINGERS.**

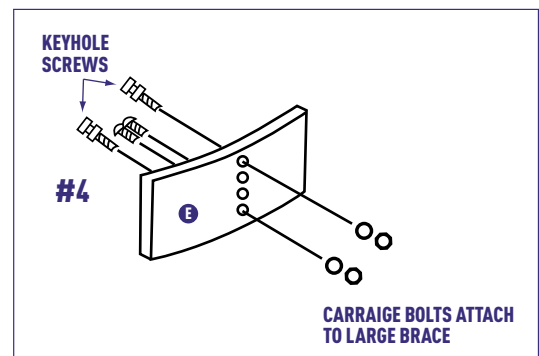

## TO ATTACH DRUMS TO STAR MULTI-CARRIER

- 1. IF YOUR SHELLS ARE ALREADY PRE-DRILLED**, your holes need to be enlarged, if necessary, by using a  $\frac{9}{32}$ " drill bit; the distance between the centers of the two holes need to be  $2\frac{3}{4}$ ". Proceed to step 3.
- 2. IF YOUR SHELLS ARE NOT PRE-DRILLED**, in order to mount your drums to the Star Multi Carrier, you will need a power drill and a  $\frac{9}{32}$ " drill bit. Two holes will be drilled into the back of each of your drums (see illustration below), the first being 3" from the top of the drum rim. After you have drilled the top hole, hold the drum up to the carrier arc, and position the top hole to align with the top square hole in the carrier, mark with a pen where the bottom hole needs to be drilled, making sure that the drum is level. The center location of the bottom hole should be  $2\frac{3}{4}$ " from the center of the top hole. Measure this before drilling the bottom hole. If correct, you may now drill this bottom hole. Drill all of your drums in this way.

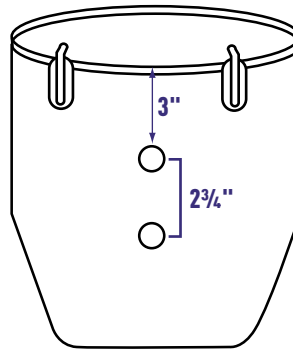

- 3. MOUNTING DRUMS**, in **TRIO** setups, you may place your drums anywhere along the multi-arc that you desire; in **QUINT** setups, you will mount the smallest drum first, in the very center inside part of the arc. Tighten nuts down with a wrench, as access to the nuts is limited once the other four drums are in position.
- 4.** In both **QUAD** and **QUINT** setups, you will normally want to position the largest drum on the far left holes and the second largest drum on the far right holes (as the player would see the arc). The third largest drum then goes next to the largest and the smallest drum goes in the remaining available space. Keep in mind that when you are positioning the drums, when you are all finished you will need to attach the enclosed stabilizer bars (which keep the drums from wobbling) and mount on the lugs of your drums. Space the drums out as much as you can with the available space.

This is how the parts need to go to mount your drums to the arc: carriage bolt; carrier (through square holes); plastic washer; drum; metal washer; nyloc nut (must be tightened with a socket wrench). See illustration below.

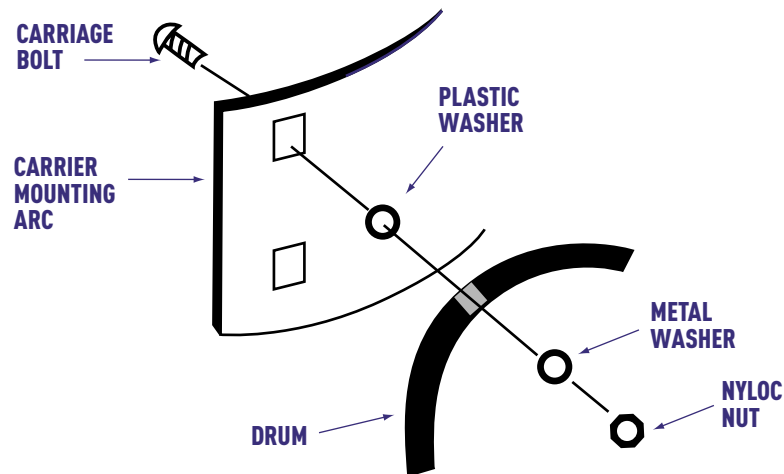

5. **STABILIZER BARS**, using a lug wrench, loosen up lugs on two drums sitting side-by-side that will accommodate the enclosed stabilizer bars. Position the stabilizer bars between the bottom of the lug heads and the plastic rings and re-tighten. See illustration below.

After making sure that all nuts are tight on the entire carrier, it is then ready to be used.

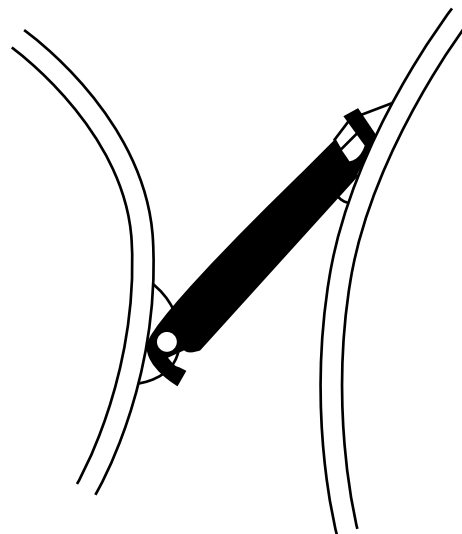

**ASSEMBLY INSTRUCTIONS FOR THE STAR J-BAR SNARE DRUM CARRIER**

**Parts List:**

- 1. Shoulder Strap ..... Qty. 2
- 2. Cross Bar .....1
- 3. Chest Support Bar .....1
- 4. Belly Plate Support Bar .....1
- 5. Belly Plate .....1
- 6. J-Bar .....2
- 7. 5/16" - 18 x 1" Carriage Bolt.....2
- 8. 5/16" x 3/4" Flat Washer.....2
- 9. 5/16" - 18 Nyloc Nut.....2
- 10. 1/4" - 20 x 1" Carriage Bolt.....6
- 11. 1/4" x 9/16" Flat Washer .....6
- 12. 1/4" - 20 Nyloc Nut.....6

Allen wrench also included with J-Bars

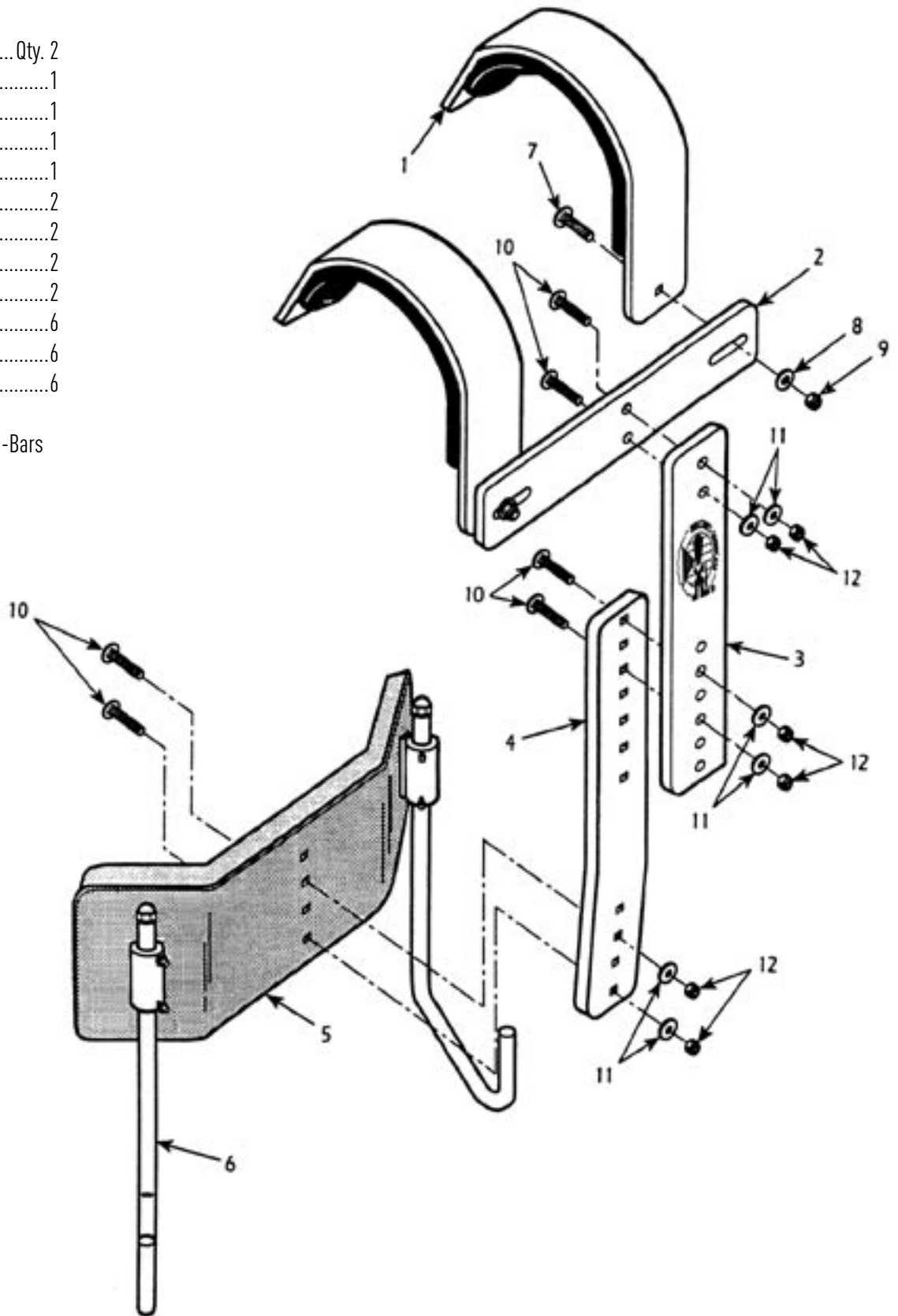

Slide straight end of J-Bar hooks through bracket. Place lock washer on top of J-Bar hole, then place Allen screw in hole and tighten. Use enclosed Allen wrench to tighten J-Bar caps and to tighten bracket once positioned correctly.

## PLACEMENT OF TILTING BRACKETS

1. Remove the drum head.
2. As shown in the image to the right, approximately 2" down from the top of shell and 9 1/2" - 10" apart from the center of the drum, locate and mark where you will need to drill the holes in the drum shell. Use the drum bracket assemblies as patterns for correct hole placement.
3. Using a 1/4" drill bit, drill holes squarely through the drum shell. We highly recommend placing a scrap piece of wood firmly against the inside of the drum shell where the holes are being drilled to avoid tearout as the drill bit goes through to the inside of the shell.
4. Secure the left bracket assembly to the left side of the drum (as shown in the top picture under the arrows) using the enclosed bolts, washers and lock nuts. The bolt should go through the bracket first and then through the shell. The washer should be placed on the bolt on the inside of the shell. Secure the lock nut on the end of the bolt (inside the drum), being careful not to overtighten.
5. Tighten all bolts on the brackets as needed to allow for tilting of the drum while on the carrier. Also adjust the stop on each bracket so the drum will be level while in the playing position.

